

PARKLIO CHAIN USER MANUAL

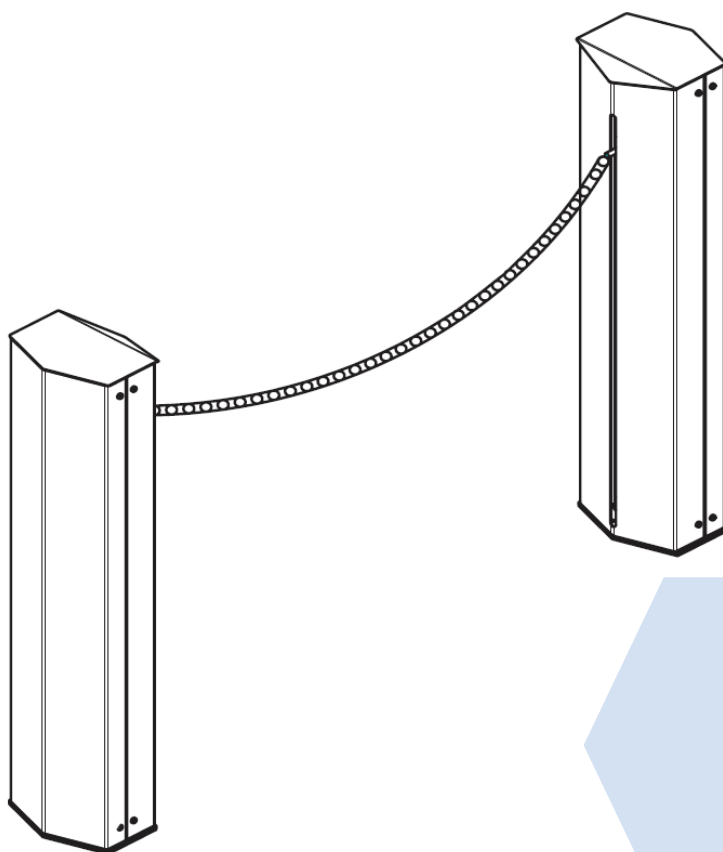

Thank you for the confidence you have shown us by purchasing our product.

Please read this manual first!

Dear Customers,

We hope that all your expectations of this product will be fulfilled. Parklio Chain is manufactured using the latest technologies and has undergone rigorous quality control procedures.

The User Guide will help you use your product quickly and safely.

- Read the user manual before installing and using your product.
- Always follow the safety instructions.
- Keep this user manual at hand for future reference.

PARKLIO CHAIN DETAILED INSTRUCTIONS

01. Lay-out	04
02. Description and dimension of the column.....	05
03. Installation	06
3.1. Preliminary controls.....	06
3.2. Installation of the column.....	06
04. Maintenance plan (every 6 months).....	07
05. CONNECTION OF THE BRAKING JOINT	07
06. Technical Data	08

01. LAY-OUT

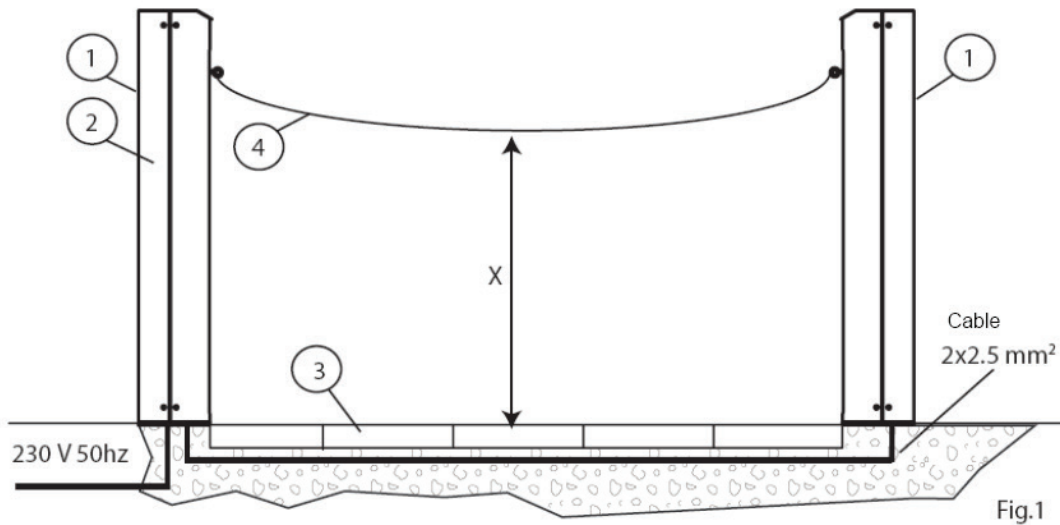

1. Parking post
2. Control unit
3. Profile for the chain
4. Chain

Length of the chain (m)	4	6	8	10	12	14	16	18	20
Relative height in the middle X (cm)	75	70	65	60	55	50	45	40	35

Attention: The value in the table has been determined using a chain of 400 grams/meter

02. DESCRIPTION AND DIMENSION OF THE COLUMN

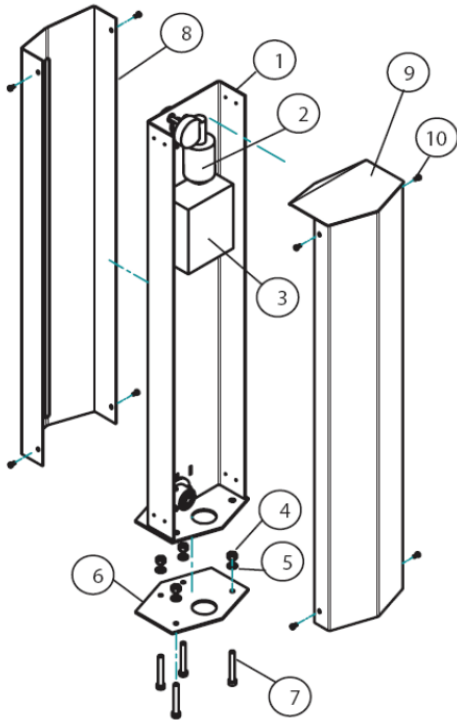

Fig.4

1. Column
2. Gear motor with encoder
3. Control unit
4. Auto blocking nut M10
5. Washer 20x10
6. Backing plate
7. Screw M10x70
8. Anterior cover
9. Posterior cover
10. Closing screw M5x10

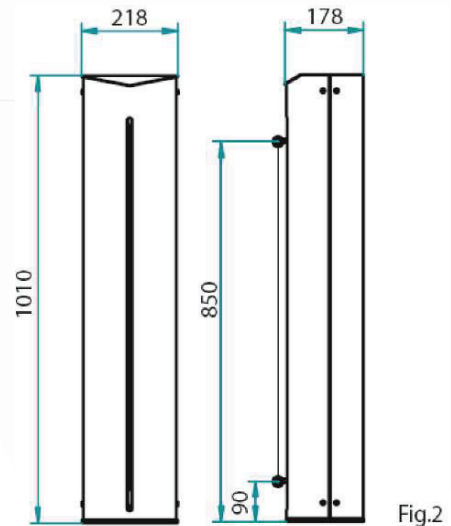

Fig.2

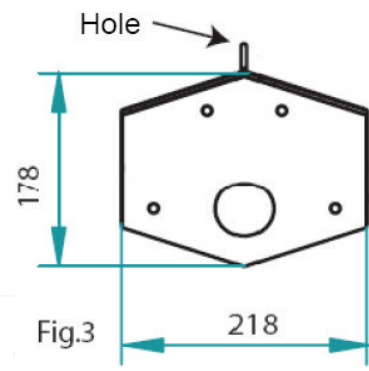
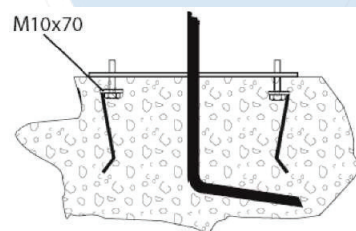

Fig.3



03. INSTALLATION

All measures are expressed in millimeters unless otherwise indicated.

3.1 Preliminary Controls

1. Control the stability and solidity of the zone where the columns are going to be fixed.
2. Use an omni polar interrupter with contact distance of at least 3mm.
3. The connection to the power supply must be separated than the connections to the security and commanding devices

3.2 Installation of the Column (Fig. 1, Fig. 2, Fig. 4)

1. Screw in for 1,5 - 2,0 cm the 4 screws M10x70 in dotation to the base.
2. Place the base on the previously prepared base of cement (Fig.3)
3. The upper part of the base should be clean and perfectly horizontal.
4. Pass the plastic tubes of the cables through the central opening on the base and check again the stability of the base.
5. Unscrew the 8 screws [10] take off the frontal [8] and the rear cover [9] of the column (Fig. 4)
6. Place now the column structure on the base.
7. Fix now the column to the base with the 4 washers [5] and 4 nuts [4].
8. Fix the frontal covers [8] of both columns with 4 screws [10].
9. Now you can fix the chain to the apposite holes on both columns respecting the level X in the middle of the chain barrier indicated at the table on page 1 (Fig. 5)

04. MAINTENANCE PLAN (EVERY 6 MONTHS)

1. Cut the power supply off or disconnect the batteries if present. Clean and grease the guide internally.
2. See if there are wired parts and replace these if necessary.
3. Grease the internal transmitting chain.
4. Check the fixation nuts.
5. Control the electrical connections
6. Supply the power again.
7. Check out the correct functioning of the obstacle recognition (encoder system).
8. Check out the correct functioning of all and of the security commands.

05. CONNECTION OF THE BRAKING JOINT



Step # 1



Step # 2



Step # 3

06. TECHNICAL DATA

Power supply	230 Vac 50 Hz
Current Draw	1.0 A
Motor Power	60 W
Motor Power	645 Nm
Service	50 %
Protection Degree	IP 34
Lubrication	Permanent
Weight	25 Kg
Max chain weight	8.5Kg